



Technology with Vision

2016 HELLA ACCESSORY GUIDE



HELLA WIPER BLADES

As a leading partner of the best-known European vehicle manufacturers, HELLA has been developing quality components and systems for the automotive industry since 1899, and it is one of the largest providers of vehicle parts and accessories worldwide.

With a wide range of high-quality accessories such as auxiliary lights, horns, lamps and wiper blades, HELLA offers a valuable contribution to road traffic safety!



You can depend on wiper blades from HELLA, regardless of how extreme the conditions are. Our aim is to keep you driving safely.

Our wiper blades are small technical masterpieces. During their service life, they wipe several thousands of litres of water off the windshield. They deal effectively with fog streaks, as well as snow, ice, insects and dirty spray water from vehicles driving in front. They may be small – but their contribution to road traffic safety is considerable. HELLA wiper blades are the must have choice when replacement blades are needed.

We at HELLA recommend that you replace your wiper blades at least once a year.

Premium Quality, Test-Proven

Expect only superior quality from HELLA. HELLA wiper blades are subjected to the highest quality requirements and meet the stringent test standards of Japanese Industrial Standards (JIS) and Society of Automotive Engineers (SAE).

→ Clearer Visibility

→ Longer-lasting Performance

→ HELLA wiper blades perform

- 83% better than Asian Brand A
- 20% better than European Brand A

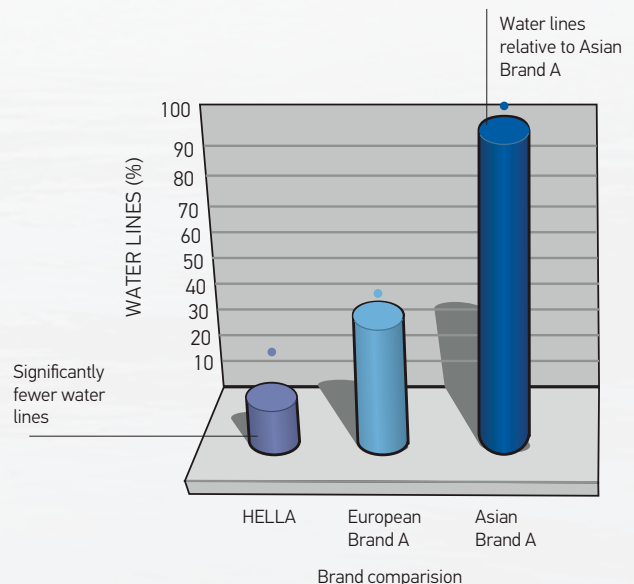

5. Wiper Blades

Standard Wiper Blades

- 1 The rubber lip is coated with graphite using nano technology and offers even, quiet operation and clear visibility.
- 2 Preinstalled adapter 5 in 1 for easy installation
- 3 Original HELLA logo printed on each wiper blade as a mark of quality
- 4 Superior solid steel frame ensures maximum strength and durability
- 5 Even contact pressure at each contact point provides clean wiping results

Materials

- Natural rubber lip is coated with graphite using nano technology
- Environment friendly and lead-free
- Solid steel frame
- Protective sleeve on each new wiper blade

Universal adapters included



E3
(Pre-installed in all our wiper blades)



B



V9



E



A2-1



Perfect sweep angle 45°, which guarantees maximum grip on the windshield.

The patented flexor prevents the blade stops in one direction allowing a minimum amount of power and energy to the wiper in each applied sweep.

Larger cross section than any wiper blade in the market, responding with maximum efficiency even in torrential rain

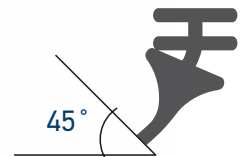

Wiper blade arm types supported

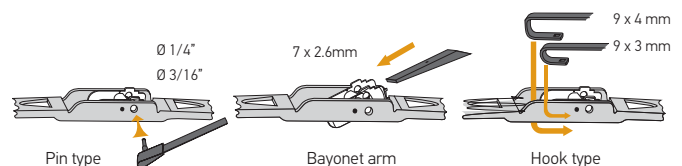

Slim masterpieces in black wiper blades are small technical masterpieces in the course of their service life. They wipe thousands of litres of water from the windscreen..

The packaging of the wiper blades provides all necessary information.

- Short number and part number
- Application chart (Brand, model, year)
- Size of the wiper blades in millimeters and inches
- EAN and UPC code
- Descriptions in 4 languages
- QR code link to installation video
- Sticker and mini catalog HELLA



HELLA car wiper blades are available in 13 lengths and come in a practical blister pack.

New packaging with descriptions in 4 languages.

Product Range

Size	Part Number	Short Number	Presentation	Included adaptors
11" / 279 mm	9XW398114011	W11STP	2 pieces	E3, B, E, V9
13" / 330 mm	9XW398114013	W13ST	Individual	E3, B, A2-1
14" / 355 mm	9XW398114014	W14ST	Individual	E3, B, V9
15" / 381 mm	9XW398114015	W15ST	Individual	E3, B, V9
16" / 406 mm	9XW398114016	W16STP	2 pieces	E3, B, V9
16" / 406 mm	9XW398114016/I	W16ST	Individual	E3, B, V9
18" / 457 mm	9XW398114018	W18STP	2 pieces	E3, B, V9
18" / 457 mm	9XW398114018/I	W18ST	Individual	E3, B, V9
19" / 482 mm	9XW398114019	W19ST	Individual	E3, B, V9
19/21" 482 / 533 mm	9XW398114019/21	W19STP	2 pieces	E3, B, V9
20" / 508 mm	9XW398114020	W20ST	Individual	E3, V9
21" / 533 mm	9XW398114021	W21ST	Individual	E3, V9
22" / 558 mm	9XW398114022	W22ST	Individual	E3, V9
24" / 609 mm	9XW398114024	W24ST	Individual	E3, V9
26" / 660 mm	9XW398114026	W26ST	Individual	E3, V9
28" / 711 mm	9XW398114028	W28ST	Individual	E3

Additional materials included in the packaging



Mini catalog in 4 languages



Mounting instructions



HELLA sticker



5. Wiper Blades

Rear wiper blades

- 1 Blade made of natural rubber-coated nano-particles of graphite, which greatly improves visibility.
- 2 Universal connectors included designed to fit different types of rear wiper arms. (See right table for adaptor content).
- 3 Original HELLA logo engraved on the structure.
- 4 Pressure points distributed along the wiper blade.
- 5 Special adapter for specific applications.

Materials

- Natural rubber lip is coated with graphite using nano technology
- Resistant frame made of PVC
- Protective sleeve on each new wiper blade

Universal adaptors included

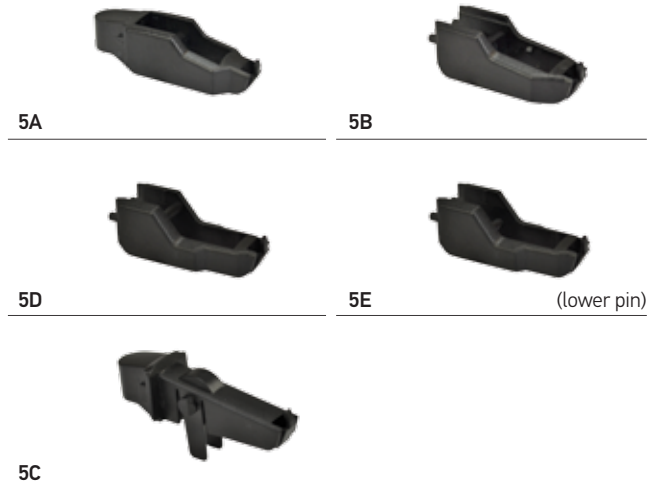

Perfect sweep angle 45°, which guarantees maximum grip on the windshield.



The original design of the new HELLA rear wiper blades facilitates its installation in vehicles that require special connectors/ adaptors.

The packaging includes:

- Part number listed on the back.
- Application table (Manufacturer, model, year of manufacture)
- Length of the wiper blade indicated in inches and millimeters
- EAN and UPC bar codes
- Special adaptors
- Descriptions in 4 languages
- Mini catalog
- HELLA sticker

Product range

Size	Part number	Presentation	Adapters included
11" / 279 mm	9XW398114011T	Individual	5A
12" / 305 mm	9XW398114012T	Individual	5A, 5B, 5E
OE Adaptor 13" / 330 mm	9XW85981013T	Individual	Special adapter for Land Rover (Free Lander), Volkswagen (Pointer)
14" / 355 mm	9XW398114014T	Individual	5A, 5B, 5C, 5D
16" / 406 mm	9XW398114016T	Individual	5A, 5B, 5E
OE Adaptor 16" / 406 mm	9XW85981016T	Individual	Special adapter for Fiat (Palio), GM (Corsa, Meriva), Volkswagen (Pointer Wagon, Pick Up)



HELLA car wiper blades are available in 4 lengths and come in a practical blister pack.

The rear wiper blades with OE adaptor are available in 2 sizes, in cardboard box.

Wiper blade arm types supported

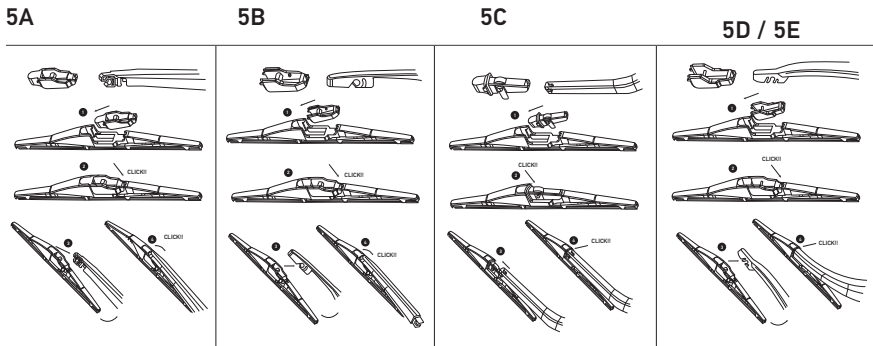

Original Equipment specifications may vary without notice.

Additional materials included in the packaging



Mini catalog in 4 languages



HELLA sticker



5. Wiper Blades

Dyna Blade wiper blades

- 1 Embossed logo on the end cap
- 2 Even contact pressure at each contact point provides perfect wiping performance
- 3 Optimum cleaning thanks to graphite-coated wiper blade
- 4 Hinges and exterior metal parts are not needed, guaranteeing trouble-free operation in winter
- 5 Quickfit thanks to 1-to-1 connection.

Dyna Blade HELLA - Features:

- The optimised, pre-contoured spring rail of the flat wiper blades ensures even force distribution at every point across the windshield. This guarantees perfect wiping performance. The even contact pressure avoids wear tips and guarantees clear visibility.
- Wind noise is kept to a minimum thanks to the flow-optimised and noise optimised geometry.
- Perfectly fitting spring rail enables effective wiper performance
- Quality test: High speed test performance at 130km/h.
Corrosion test: 144h SSR (DIN EN ISO 9227), UVA 500h ISO 4892-2 / DIN EN 20105-A02.
- Range: Less part numbers - more applications, 10 sizes
14" - 28" (350 mm - 700 mm)
- 7 adaptadors included for easy installation:

Universal adaptors included

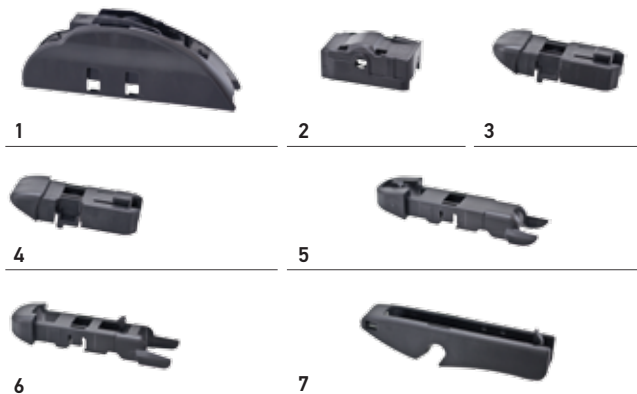

The country of origin changes from USA to China

Dyna Blades from HELLA – the new flat wiper blades.

The optimally contoured vertebrae of the new Dyna Blades provide even distribution of force across every point of the windshield, guaranteeing perfect wiper performance. The even contact pressure prevents wear points developing.

A multi-adapter is preinstalled in all Dyna Blades. That means the new wiper blades can be retrofitted to older vehicles as well. For more recent models, additional adapters for wiper arms are included in the package.

Product range

Size	Part number	Dyna Blade Short code	Presentation
16" / 406 mm	9XW16S	WBU16	Individual
18" / 457 mm	9XW18S	WBU18	Individual
19" / 482 mm	9XW19S	WBU19	Individual
20" / 508 mm	9XW20S	WBU20	Individual
21" / 533 mm	9XW21S	WBU21	Individual
22" / 558 mm	9XW22S	WBU22	Individual
24" / 609 mm	9XW24S	WBU24	Individual
26" / 664 mm	9XW26S	WBU26	Individual
28" / 711 mm	9XW28S	WBU28	Individual



HELLA has now achieved market coverage of 98% with the introduction of the new wiper blade range.

Diagram

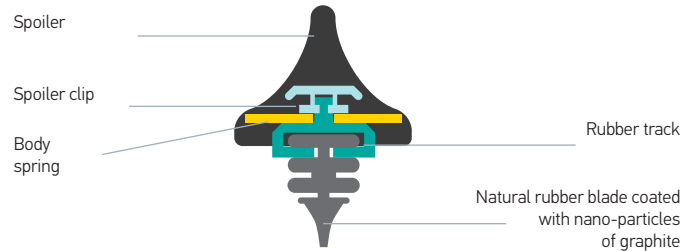

The air flow provides optimum pressure and thus a better contact, preventing wind uplift due to high speeds.

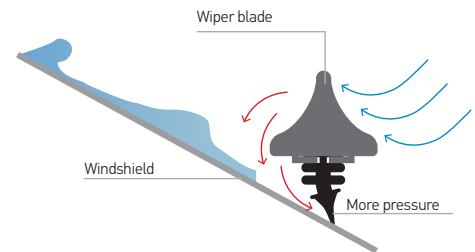

5. Wiper Blades

Heavy Duty wiper blades

OUR RANGE OF WIPER BLADES FOR COMMERCIAL VEHICLES

Wear-free edge for perfect wiping results to the very end of service life
Environmentally friendly and lead-free
Protective lip on each new wiper blade

Materials

- 1** The rubber lip is coated with graphite using nano technology and offers even, quiet operation and clear visibility.
- 2** Original HELLA logo printed on each wiper blade as a mark of quality
- 3** Superior solid steel frame ensures maximum strength and durability
- 4** Even contact pressure at each contact point provides clean wiping results



Product range

Size	Part number	Supported arm	Presentation
28" / 711 mm	9XWHD028	PIN	Individual
32" / 812 mm	9XWHD032	PIN	Individual
36" / 914 mm	9XWHD036	PIN	Individual
40" / 1016 mm	9XWHD40H	Hook	Individual
40" / 1016 mm	9XWHD040P	PIN	Individual

P = Pin H = Hook

